

## Substructure shell

# PCI-Pecibord

for barrier free shower facilities

# 470

### USES

- For indoor use.
- For ground level and **barrier free** entry to shower facilities.
- As a substitute screed in shower areas.
- For moisture load grade I and II acc. to ZDB leaflet „Information on the application of waterproof coatings directly under claddings and coverings such as tiles and flags for indoor and outdoor application“, edition August 2000.
- For renovation and new buildings.
- For public, commercial and private use.



After filling the recess PCI-Pecibord is installed on the even substrate by applying PCI-Flexmörtel and/or PCI-Polyflott flex void-free over the entire area.

### USER BENEFITS

- **Substructure element with integrated slope**, for ground level and barrier free entry to shower facilities.
- **Reduced thickness of the structure element of only 40 mm.**
- **Floor drain is adjustable** and infinitely variable to various tile thicknesses.
- **Good thermal insulation**, in comparison to a usual cementitious screed PCI-Pecibord helps prevent heat loss through floor tiles.
- Corresponds to the guidelines in bath construction / sanitary field.



## USER BENEFITS

- **Separates the tile covering from the substrate**, bridges cracks in the substructure and critical substrates (such as timber flooring boards).
- **Secure waterproofing** even in critical areas such as floor and wall junctions as well as floor drains with the PCI-Seccoral 2K complete tanking system.
- **Fast application**, no waiting time in comparison with the application of usual cementitious screeds.

## TECHNICAL DATA

### SUBSTRUCTURE SHELL / FLOOR ELEMENTS

Material base	foamed CFC/HCFC free polystyrene board with special mortar coating on both sides
Board format (substructure shell)	100 x 100 cm and/or 120 x 120 cm
Thickness of board	40 mm
Slope of shell	approx. 2%
Labelling for	
- Regulation for hazardous goods on roads	non hazardous
- Regulation for hazardous substances	no labelling requirement for this product

### FLOOR DRAIN (DIN 19 599)

Description	Kessel floor drain DN 50
Material base	acrylic butadiene styrene co-polymer
Drain capacity	0.8 ltr/sec
Grid size	100 x 100 mm (stainless steel)
Installation depth	approx. 120 mm (with horizontal drain)

### PACKAGING

System components

**PCI-Pecibord:** Polystyrene mold (coated with special cement mortar) with integrated slope and sealed-in connection for Kessel floor drain

substructure shell 100 x 100 cm

substructure shell 120 x 120 cm

**Kessel floor drain** (available for vertical or horizontal connection)

vertical and horizontal floor drain (incl. stench trap)

**Kessel attachment with grid**

grid 100 x 100 mm

## **SUBSTRATE PREPARATION**

### **Requirements/conditions on site:**

- Before installing PCI-Pecibord an even, sound and clean substrate must be prepared. Its level must be 45 to 50 mm below the screed surface (can be achieved with PCI-Periplan, PCI-Fließspachtel 15 or – at layer thicknesses larger than 20 mm – with PCI-Novoment plus or PCI-Periplan plus).
- A recess must be available in the floor with a DN 50 drain pipe installed which is 95 to 100mm below the screed surface (measured from the middle of the drain pipe at a horizontal drain). At vertical drains it is required to drill a borehole in the concrete surface with an approximate diameter of 200 mm.
- If PCI-Pecibord should be installed in combination with the impact sound insulation PCI-Polysilent plus the even substructure must range between 55 and 60 mm below the surface of the screed.
- Suitable substrates are concrete floors, timber flooring boards, cementitious screeds, plaster and anhydrite pourable screeds as well as combinations of heat/impact sound insulation boards which are resistant to pressure and installed void-free.
- Irregularities in the substrate can be levelled with the levelling compound PCI-Periplan or PCI-Fließspachtel 15.

## **APPLICATION**

- 1** The bottom of the floor drain must be inserted – in rotary motions as far as it will go - into the end of the sleeve of the DN 50 drain pipe provided by the builder. If required cross-cut the drain pipe at the end which is facing away from the sleeve.
- 2** Soundproof the drain pipe and the lower part of the floor drain by tightly wrapping them with a sound-proof tape (e.g. available from Misselfix).
- 3** Fit the lower part of the floor drain in the correct position by using the provided template and fix it with PCI-Repafix or PCI-Polyfix 5 Min. approx. 5.5 cm below the top edge of the screed (measured from top edge of ring web of the lower part of floor drain, see drawing). Remove the template and fill the recess in the floor around the DN 50 drain pipe with PCI-Novoment plus or PCI-Vergussmörtel.
- 4.1** Immediately after filling the recess PCI-Pecibord can be installed on the even substrate with PCI-Flexmörtel or PCI-Polyflott flex applied over its entire surface. The sealing lip of the floor drain integrated in the PCI-Pecibord should be greased with suitable lubricant beforehand.

## APPLICATION

**4.2** If PCI-Pecibord is installed at a later date the radial sealing ring and protecting ring should be attached and protected by the violet protecting cover. Prior to the installation of PCI-Pecibord, remove protecting ring with radial sealing ring and protecting cover and install PCI-Pecibord as described under 4.1.

**5** After adjusting PCI-Pecibord (**black plastic protecting ring is not used any more**) re-insert the radial sealing ring in the floor drain; insert mating flange in the existing hollow and fix by means of the 6 screws provided.

**6** Waterproof the installed PCI-Pecibord elements with PCI-Seccoral, applied by brush or trowel.

**7** Apply PCI-Sicherheits-Dichtband 120 with PCI-Seccoral at floor/wall junctions as well as butt joints between substructure shell and screed.

**8** Apply second layer of PCI-Seccoral by roll and allow to cure.

**9** Cut attachment piece with grid to required length, grease slightly and insert in radial sealing ring; the exact height can be adjusted by underlaying with adhesive when fixing tiles.

**10** Tiles and slabs can be laid with PCI-Flexmörtel or PCI-Polyflott flex.

**11** Wall and floor joints can be grouted with PCI-Flexfug, PCI-Aquafug or PCI-Fugenbunt and/or with PCI-Rigamuls Color if resistance to chemicals is required. The connection joint with integrated PCI-Sicherheits-Dichtband 120 between PCI-Pecibord and screed must be adopted in the tile covering at the same place and grouted with the elastic sealant PCI-Silcoferm S just like wall junctions and movement joints.

**Installation depth for PCI-Pecibord with horizontal (1) or vertical (2) drain**

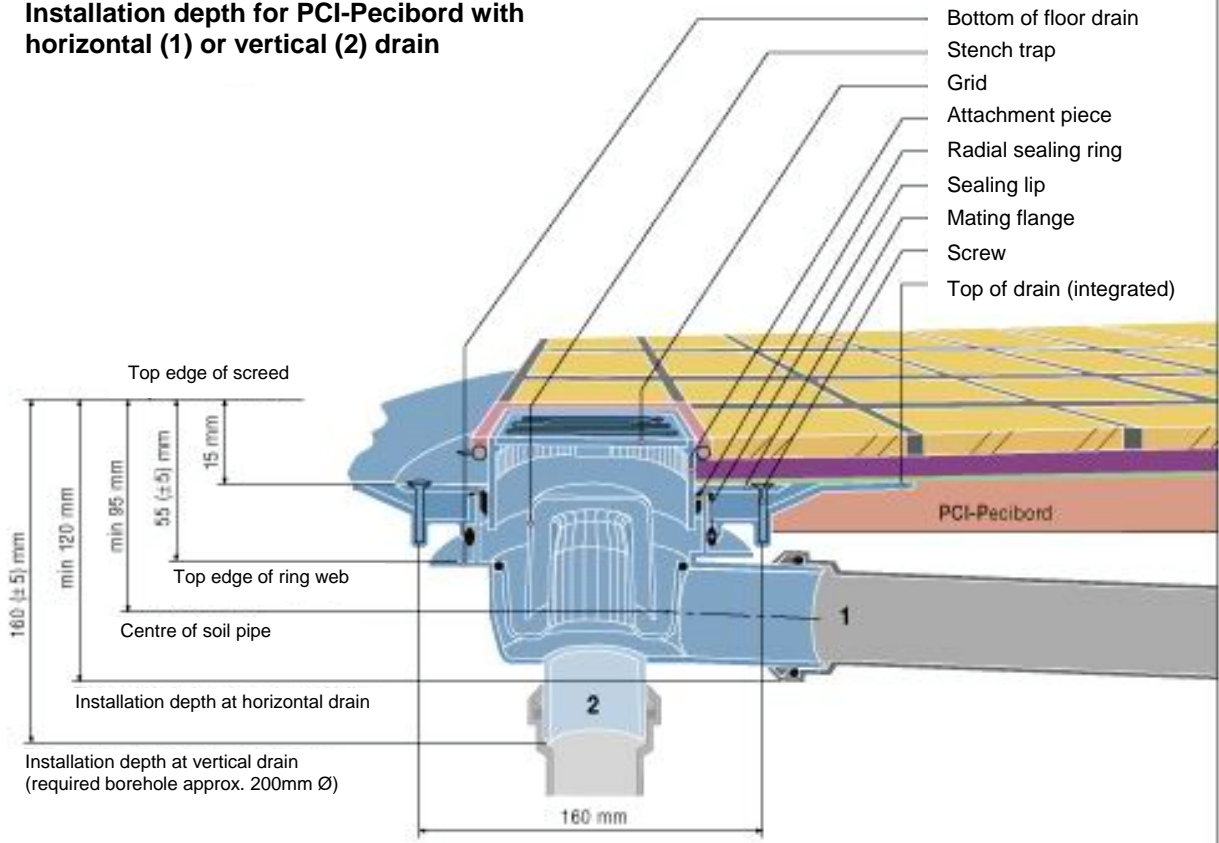

**Installation on old timber flooring**

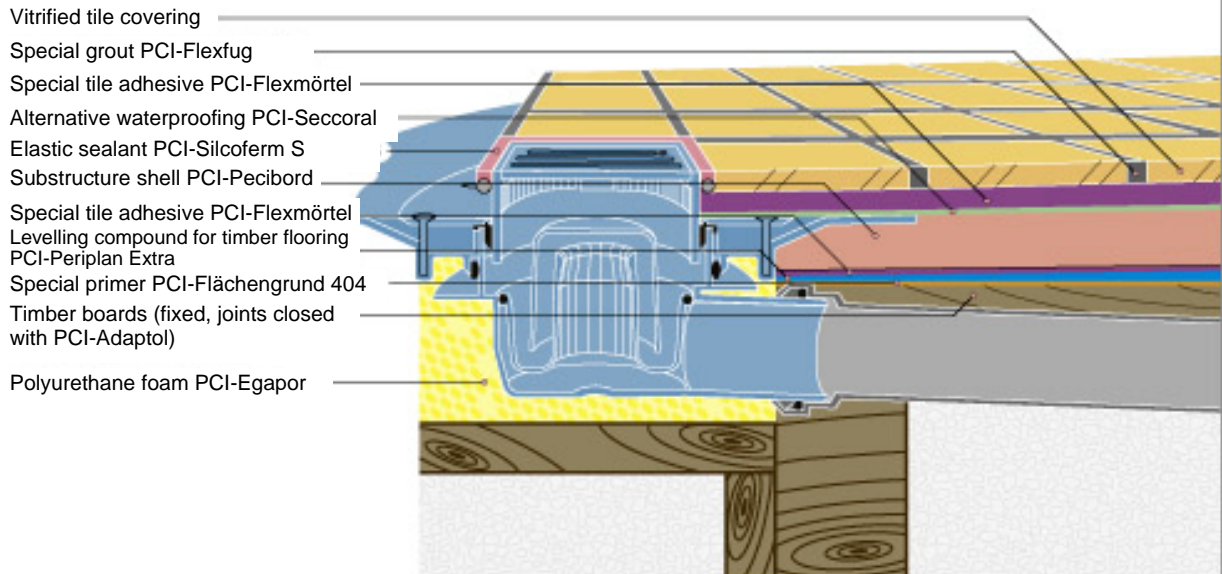

**Installation with impact sound and thermal insulation installed on site**

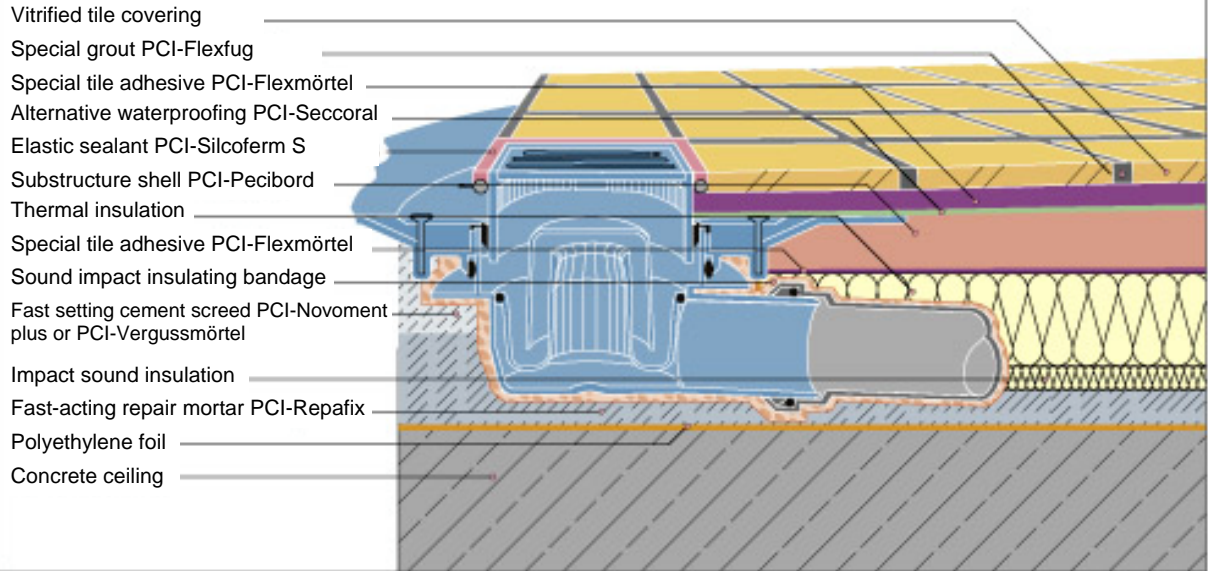

**Installation with impact sound insulation PCI-Polysilent plus installed at a later date**

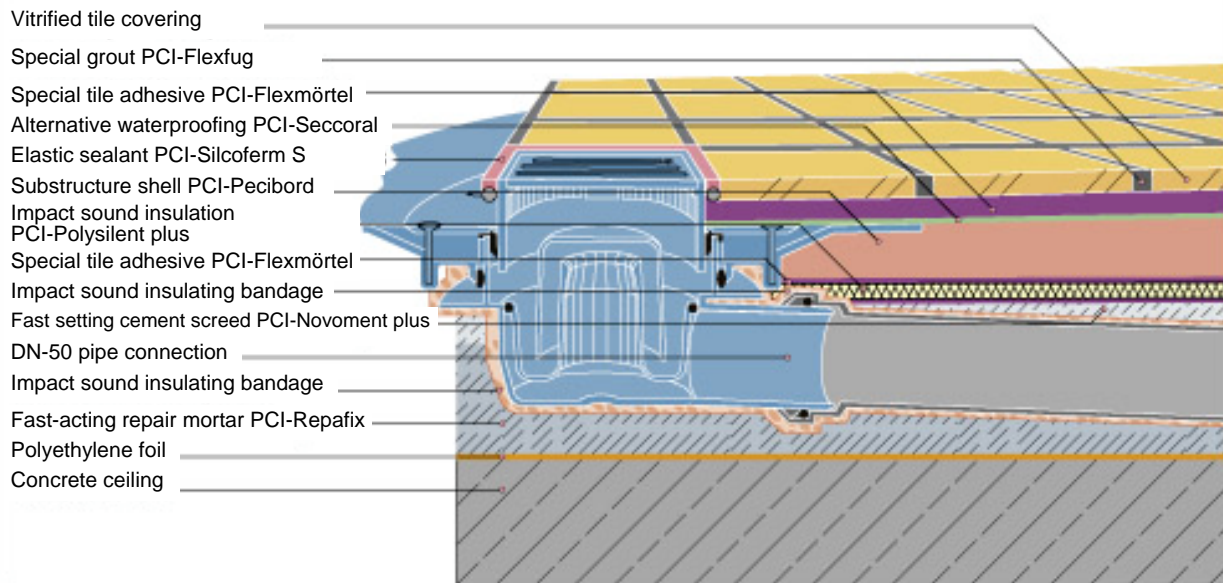

### Connection to floating screed on site

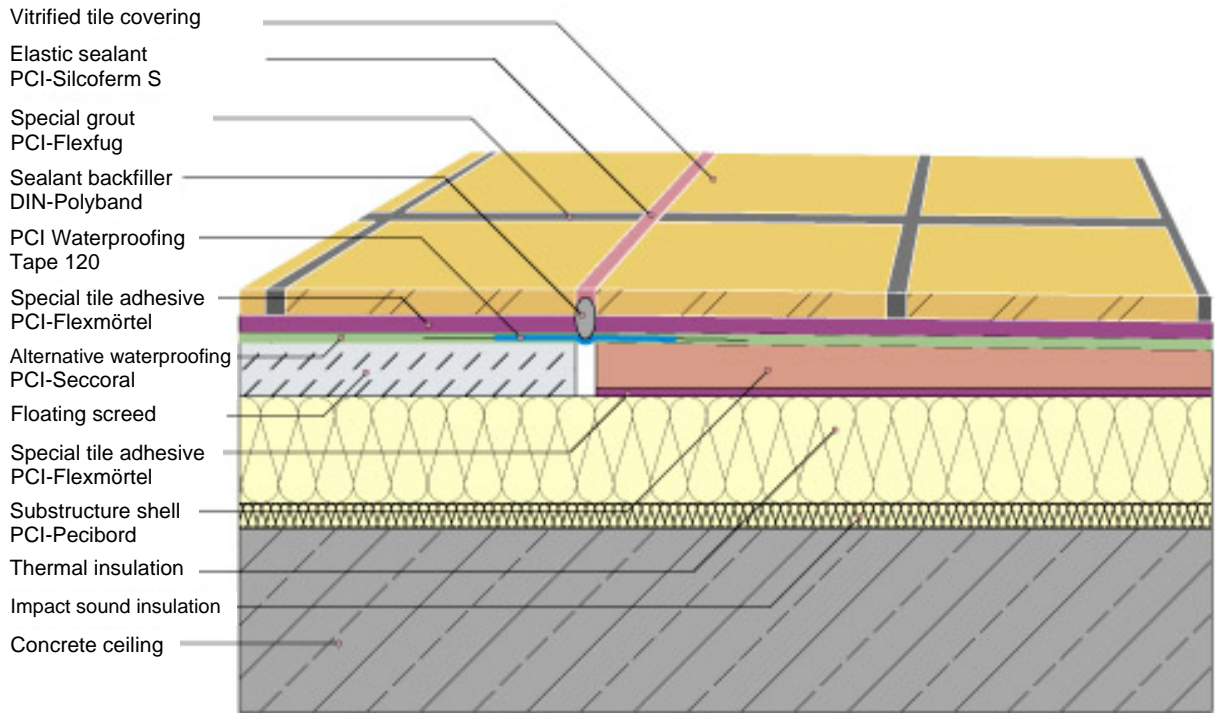

### Design of wall junction area

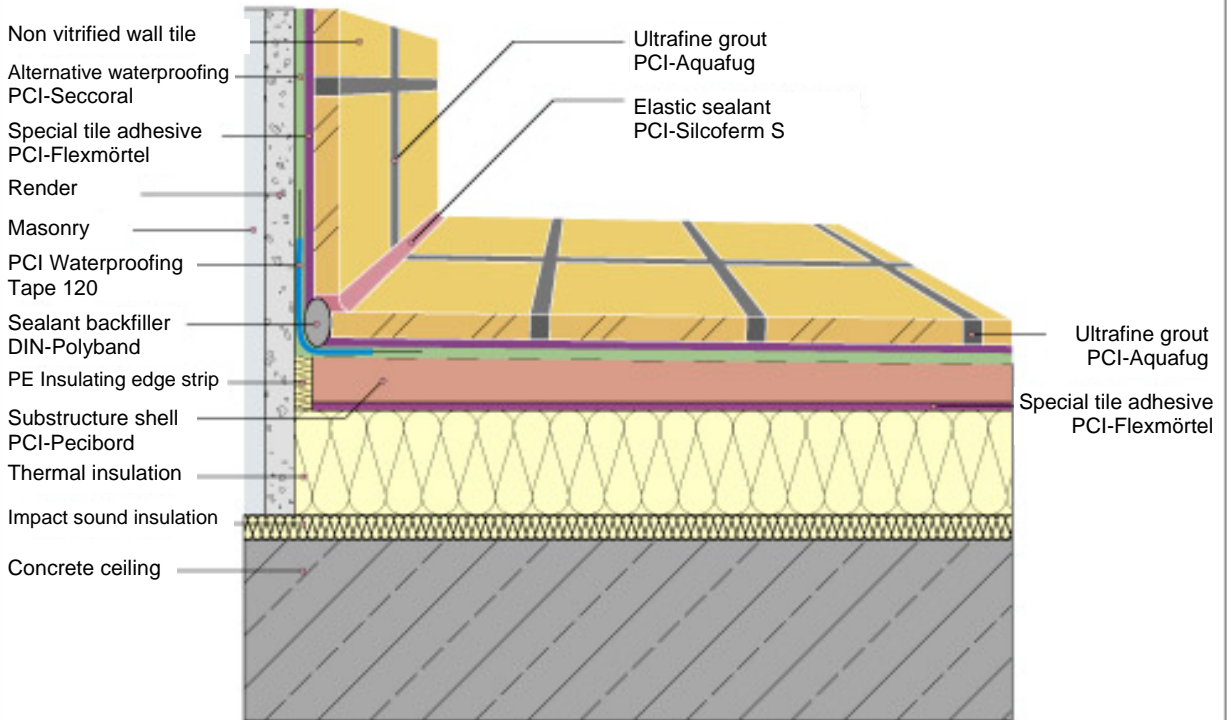

## PLEASE NOTE

- To guarantee a trouble-free installation we recommend the tiler to arrange with the plumber.
- Make sure during the application that PCI-Pecibord is always bearing on its full area.
- To achieve a floor structure with impact sound insulation PCI-Polysilent plus can be applied underneath PCI-Pecibord (please contact the Technical Help-Line).
- To lay mosaic coverings thinner than 6 mm PCI-Pecibord can be installed lower and the area around the floor drain can be levelled in a thickness to raise the covering to drain level.
- The Kessel floor drain and Kessel attachment are also available directly from distributors.
- The ceramics must at least correspond to the anti-slip safety grade „B“ to comply with the GUV-26.17 leaflet „Floor coverings for barefoot areas exposed to wetness (April 1986)“.
- Store in dry areas.

### PCI Augsburg GmbH

Piccardstr. 11  
86159 Augsburg  
P.O.B. 10 22 47  
86012 Augsburg  
Germany  
Phone 0049 (0) 821/59 01-0  
Fax 0049 (0) 821/59 01-390  
www.pci-augsburg.de

In view of widely varying site conditions this data sheet is meant to provide general application guidelines only. Any recommendation or information issued by us constitutes a preliminary and accessory contractual obligation only. Users must satisfy themselves regarding the applicability of the content to their own particular requirements. Please contact our Advisory Service for special requirements.

Liability is accepted for incomplete or incorrect particulars in our information material only in the event of intent or gross negligence, without prejudice to claims under product liability laws. All transactions are subject to our Terms of Sale and Supply. Any subsequent publication supersedes this edition.  
Edition January 2004. Reprint 04.04.

Ein Unternehmen der  
**degussa.**